

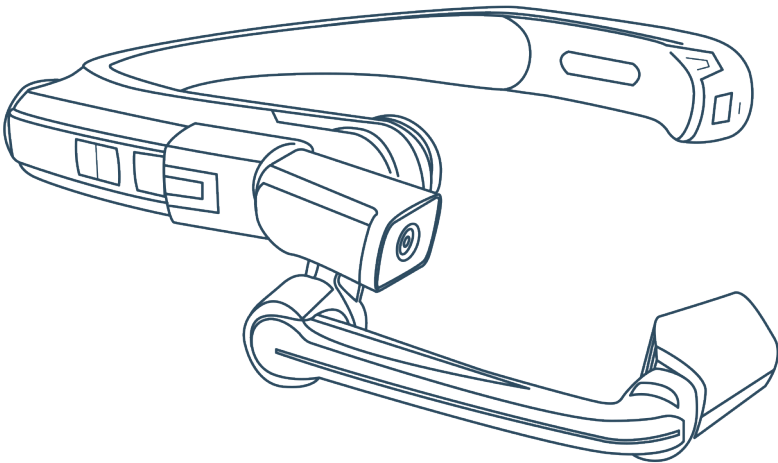

Digital Accelerator



RealWear

Getting Started

XpertEye Essential

amaxperteye.com

Before you begin

IN ORDER TO USE XPERTEYE ESSENTIAL, THE REALWEAR DEVICE MUST BE CONFIGURED. TO DO SO, CREATE QR-CODES USING A WEB BROWSER.

TECHNICAL REQUIREMENTS:

Software compatibility

- XpertEye is compatible with Android, iOS, Windows, Linux and MacOS.
- Create QR-CODES using Google Chrome, Edge or Safari.

Server Region QR generator URLs

Warning:

- *Please make sure all users are set up using the same server region.*
- *If your company has its own environment, please contact your administrator or IT department to get the dedicated URL.*

- AMERICAS (North, Central and South America): <https://americas.xe.live/qr/>
- CHINA (China): <https://xelive.com.cn/qr/>
- GLOBAL (Worldwide) and APAC (Asia-Pacific): <https://xe.live/qr/>

OVERVIEW:

- A. Configuring the RealWear device
- B. Logging in to XpertEye Essential
- C. Switching off the RealWear device
- D. Charging the RealWear device
- E. Changing the language on the RealWear device

A. Configuring the RealWear device

The RealWear requires an Internet connection. The connection is created using a configuration QR-CODE.

If the device is already configured, go to section B - "Logging in to XpertEye Essential".

1

To create a configuration QR-CODE, open a web browser and go to the Server Region QR generator required (URLs provided in the "Before you begin" section) and select **Configuration**.

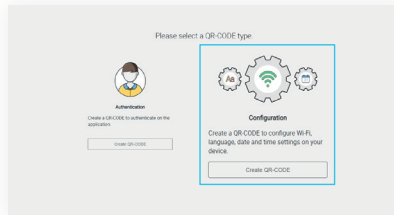

2

Select the **RealWear** device.

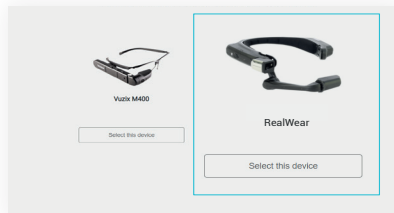

3

Click on **Language** > **DETECT AUTOMATICALLY** or select the language to be used for the voice commands.

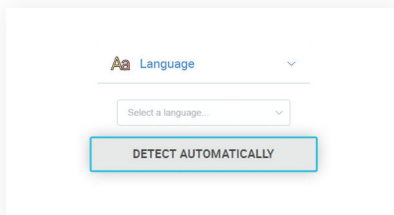

4

Click on **Date & Time** > **DETECT AUTOMATICALLY**.

5

In the **Hour** field, tick the **Select this time zone** box.

6

Click on **Wireless Network**, enter the access point name (Wi-Fi name/SSID).

7

In the **Security type** field, select **WPA/WPA2 PSK** in the drop-down list. If necessary, contact the IT department to find the correct security type information.

8

Enter the password.

Note: To show the password, click on .

9

Click on **CREATE QR-CODE**.

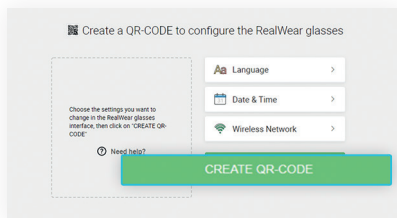

For ease of use, **PRINT**, **EXTEND**, or **DOWNLOAD** the QR CODE from the website.

10

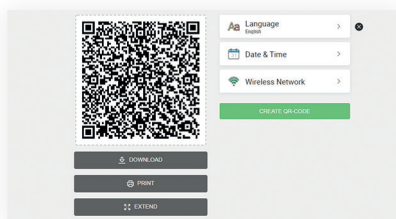
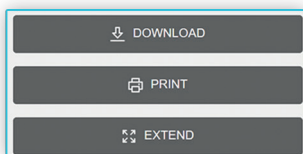

Put the RealWear device on your head and adjust the camera and the display pod as shown below.

11

N500

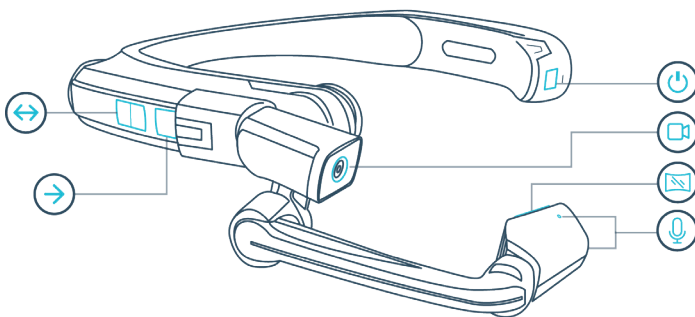

HMT

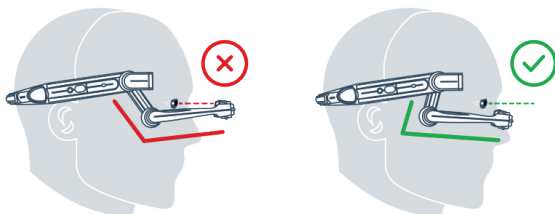
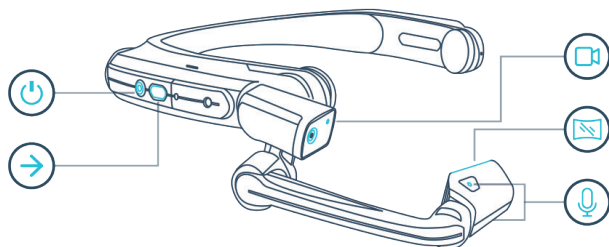

Turn on the RealWear device by pressing the power button  for 5 seconds. When the RealWear device starts up, the RealWear logo is displayed and a startup sound will be heard after a few seconds.

When the home page appears, say **“MY PROGRAMS”**.

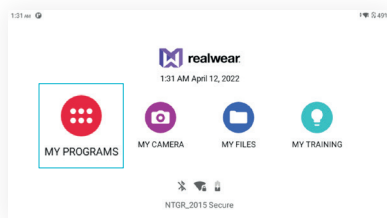

Note: When using voice commands, speak loudly and clearly into the microphone. Pay attention not to cover the microphones with your fingers.

Say **“CONFIGURATION”** or the appropriate item number: **“Select Item 7”**.

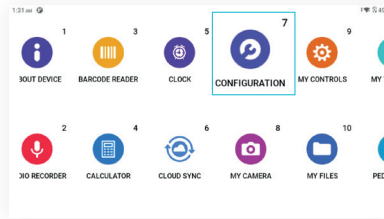

Scan the QR-CODE with the camera of the RealWear device pointing at the QR image. You can use the screen to ensure a proper framing. A sound indicates that the QR-CODE is recognized.

Say **“Navigate home”**.

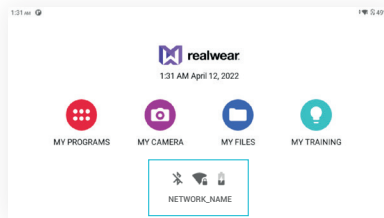

After the QR-CODE is scanned, the RealWear device is configured. The connected network should be displayed at the bottom of the home page.

Note:

- After scanning the QR-CODE, the connected network may take a few minutes to appear at the bottom of the screen. Verify with the Wi-Fi signal meter at the top right of the screen (refer to key below).
- If the network is not connected, try to reconfigure the network using a new configuration QR-CODE, paying attention to the spelling and case of your Wi-Fi name and password or contact your IT department for assistance.
- The Wi-Fi setup needs to be performed once for each new network.

- 📶: Network connected
📶: Network not connected

B. Logging in to XpertEye Essential

A login QR-CODE is required to log in to XpertEye Essential.

1

To create a login QR-CODE, open a web browser and go to the Server Region QR generator required (URLs provided in the "Before you begin" section) and select **Authentication**.

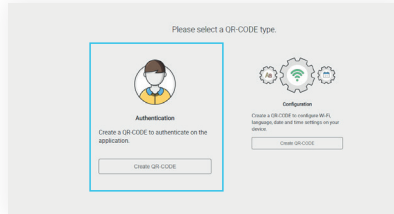

- a. Enter username and password. If you do not know your login credentials, please contact your XpertEye administrator or IT department.
- b. Select your server region.

Warning:

- Please make sure all users are on the same server region. Otherwise, contacts might not be seen as online.
- If experiencing stability issues when using the XpertEye solution on the GLOBAL server region with contacts located in Asia or Oceania, we recommend selecting the APAC server region.

2

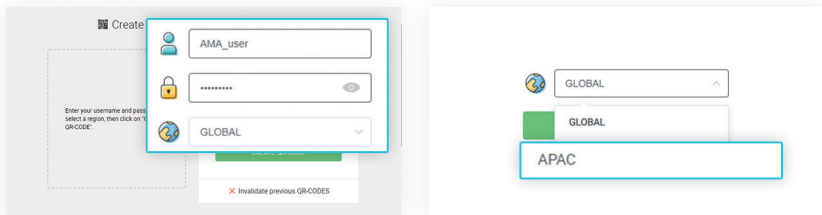

Note: To cancel previously created QR-CODES, enter username and password, click on **Invalidate previous QR-CODES** and confirm.

Click on **CREATE QR-CODE**.

3

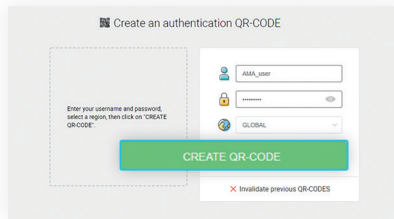

For ease of use, **PRINT**, **EXTEND**, or **DOWNLOAD** the QR-CODE from the website.
Note: Once the QR code is created, you can access the XpertEye Essential user documentation clicking on **DOCUMENTATION**.

4

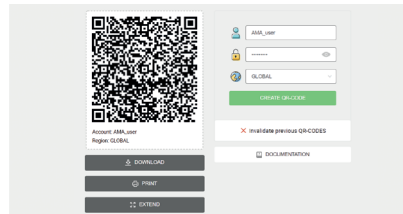
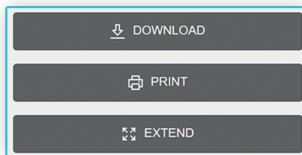

5



On the RealWear device, say **"MY PROGRAMS"**.

6

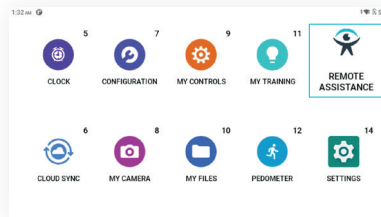
Say **"Remote Assistance"** or the appropriate item number: **"Select Item 13"**.



7

Scan the QR-CODE with the camera  of the RealWear device pointing at the QR image. You can use the screen  to ensure a proper framing. Once logged in to XpertEye Essential, you can call a contact or receive a call.

Note: You must scan the login QR-CODE every time XpertEye is launched.

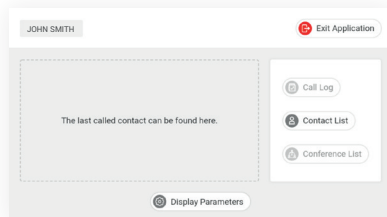

C. Switching off the RealWear device

Press the power button  for 3 seconds to switch off the RealWear device.

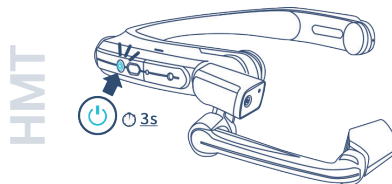
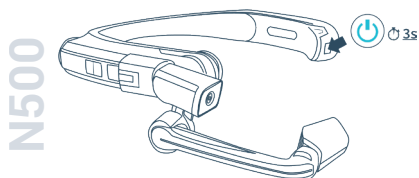

D. Charging the RealWear device

Connect the micro USB cable to the HMT-1Z1 device as shown below.

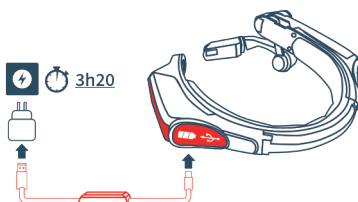

Warning: Only use the provided charger.

Connect the USB-C cable to the RealWear N500 or HMT-1 device as shown below.

Note: Depending on the RealWear model, the side of the USB-C port may change.

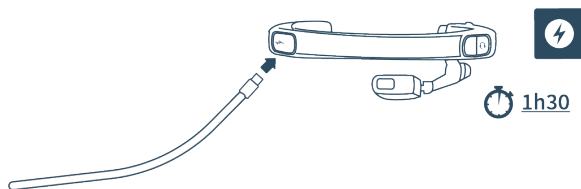

E. Changing the language on the RealWear device

If you need help to use the buttons, please see the diagrams page 5 & 6.

To change the language directly on the device, press 3 seconds the action button →, then select the language using the navigation button. Confirm by pressing the action button, then validate the selection.

N500

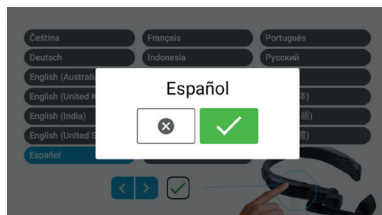

HMT

To change the language directly on the device, press and hold the action button →, release it when the desired language is highlighted and go back to XpertEye.

