

User guide

Iristick.Z1

Essential & Premium

for Android™

<https://iristick.com/>

Welcome to Iristick

Welcome to the beginning of your AR journey. With the Iristick industrial smart safety glasses, you will experience the endless possibilities of augmented reality.

Your new Iristick smart glasses – the Iristick.Z1 – are the result of more than five years of experience, research and development and our constant pursuit of perfection. Our goal is to make a wearable device that can truly support deskless workers in the field and connect them to real-time information and support from remote experts.

The Iristick.Z1 is manufactured by Iristick NV in Antwerp, Belgium. Proud winner of a Red Dot Design Award (2018), H2020 European Commission Innovation Grant (N° 811820) in 2018 and holder of multiple patents.

Thank you for your support.

The Iristick Team

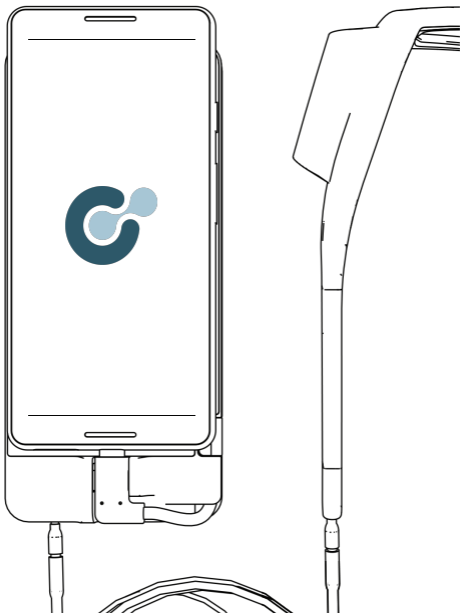

Table of contents

WELCOME TO IRISTICK	2
TABLE OF CONTENTS	3
IMPORTANT USER INFORMATION	5
Safety guidelines & warnings	5
Temperature	5
Warranties & duties	5
SAR	5
PACKAGE CONTENTS	6
QUICK START	7
HEADSET	8
POCKET UNIT	9
SERIAL & MODEL NUMBER	10
PHONE	11
Phone compatibility	11
Metal plate	12
SOFTWARE	13
Iristick Services	13
Synchronizing	13
Setup	14
Status	16
Wizzeye	17
Iristick Examples	17
Iristick Camera	18
Iristick Image Viewer	18
Partners	18
CHARGING & STATUS	19
Pocket unit status	19
Swappable plugs	19
Connecting the charger	20
Charging the phone & pocket unit together	21
Charging by USB	22
Battery & charger	23
ADJUSTMENTS	24
Temples	24
Heads-up display	24
Nose pads	25
Insertable prescription glasses	26

NAVIGATION	27
Touchpad	27
Voice commands	28
NATO phonetic alphabet	29
MAINTENANCE	30
Cleaning the glasses	30
Storing the glasses	31
SDK & DEVELOPMENT	32
Examples & source code	32
Web console	32
Partner program	32
TROUBLESHOOTING	33
CERTIFICATIONS	34
CE	34
EN60950	34
EN55032-CISPR32 Class B ITE	
(Information Technology Equipment)	34
IEC 60825-1:2014	34
EN 166 S	34
FDA compliance	34
Manufacturing information	34
ENVIRONMENTAL INFORMATION	35
Waste electrical & electronic equipment	35
Disposal of batteries in the product	35
RoHs compliance	35
BARCODE EXAMPLES	37

Please download the latest version of this user guide at <https://supportiristick.com/> as Iristick may update this user guide without giving notice.

Important user information

Safety guidelines & warnings



- Use of controls or adjustments, or carrying out procedures, other than those specified herein may result in hazardous radiation exposure.
- Never aim any laser towards an aircraft or moving vehicle.
- Do not use the Iristick.Z1 while operating a vehicle.
- Always push the heads-up display up, out of the line-of-sight when not in use.
- Never use a charger and/or adapter that looks damaged and/or has been tampered with.
- Do not charge and/or use the Iristick.Z1 in humid environments.
- Do not submerge the Iristick.Z1 and/or any of the accessories in any kind of liquid, in order to avoid electrocution.
- Do not use and/or charge the Iristick.Z1 in ATEX (explosive atmospheres).
- Do not open the Iristick.Z1 and/or any of its accessories, in order to avoid fire or electrocution.
- Always disconnect the headset from the pocket unit by removing the coaxial cable in-between before cleaning the Iristick.
- Always disconnect the pocket unit from its charger and the phone before cleaning the pocket unit and/or the charger.
- Stop using the Iristick.Z1 and/or the mobile phone if you experience nausea, dizziness and/or any other complication that might be caused by wearing and/or using the Iristick.Z1 and/or the mobile phone.

Temperature

The Iristick.Z1 has been designed to work in environments with a temperature between 0°C and 40°C (32°F and 104°F). Temperatures outside this range may damage the Iristick, resulting in malfunctions.

Warranties & duties

The Iristick.Z1 and its accessories come with a 1-year worldwide limited warranty which starts counting on the date of purchase as stated on the invoice.

SAR

As the Iristick.Z1 does not transmit any radio frequency such as Bluetooth, Wi-Fi or cellular radiation, a meaningful SAR-value cannot be measured. The amount of radiation the other electronics transmit is negligible.

Of course, the phone used in combination with the Iristick.Z1, has its own measured SAR value.

Package contents

1. **Carrying case** to store and protect the Iristick.Z1 and its accessories.
2. **Pouch** to package and protect both the smartphone¹ and pocket unit and clip to a belt.
3. **Barrel jack charging adapter** which charges the pocket unit and the phone when connected. Comes with swappable, regional plugs.
4. **Metal plate** for mounting a mobile phone magnetically onto the pocket unit.
5. **Headset**: the actual smart safety glasses.
6. **Pocket unit**: a battery and the connection between the headset and mobile phone with USB Type-C™ or lightning connection.
7. A **coaxial cable** to connect the headset to the pocket unit.

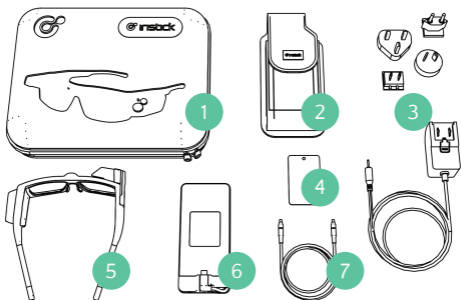

Optional accessories:

- **Android™² or Apple iOS³ device** with or without pre-installed applications and a charging adapter with USB-C or lightning cable.
- **Extra pocket unit(s)** for more battery power.
- **In-ear headphones** with microphone and 2.5mm plug.
- **Insertable prescription glasses.**

i – One or more accessories might already be included in your package.

– Please contact us at info@iristick.com for more information about the available accessories.

¹ See <https://support.iristick.com/> for an up-to-date list of supported (and unsupported) and tested phones.

² Android is a trademark of Google LLC.

³ Apple is a trademark of Apple Inc.

Quick start

You can use this section to get started with your Iristick.Z1 right away and refer to the sections in the manual if parts are unclear. However, it is still advisable to read through the complete manual in order to learn all the ins and outs of the Iristick.Z1.

Please follow the steps below to continue with the quick start:

1. Get an Android device with at least Android 7 installed and a USB Type-C connector with host mode enabled.
[Phone > Phone compatibility \(p. 11\).](#)
2. Download and install the **Iristick Services** application through Google Play⁴, F-Droid or via our developer webpage.
[Software > Setup > step 1 \(p. 14\).](#)
3. Start the **Iristick Services** application and grant the permissions.
[Software > Setup > step 2 \(p. 14\).](#)
4. Connect the phone to the pocket unit via USB and tap 'OK' in the dialog on the phone's screen to open the **Iristick Services**.
[Software > Setup > step 3 \(p. 14\).](#)
5. Connect the headset to the pocket unit with the coaxial cable and tap '**START NOW**' in the dialog on the phone's screen to activate the heads-up display.
[Software > Setup > step 4 \(p. 15\).](#)
[Software > Setup > step 5 \(p. 15\).](#)
6. Use the touchpad and/or voice commands to navigate through the menus and lists of the phone and launch for example our remote assistance demo application **Wizzeye**, the **Iristick Examples** or the **Iristick Camera**.
[Software > Wizzeye \(p. 17\).](#)
[Software > Iristick Examples \(p. 17\).](#)
[Software > Iristick Camera \(p. 18\).](#)
[Navigating > Voice commands \(p. 28\).](#)

⁴ Google Play is a trademark of Google LLC.

Headset

1. **Heads-up display** which can be adjusted in four directions and rotated to personal preference.
2. **Center camera** for a view from the user's perspective.
3. **Adjustable nose pads** for user comfort.
4. **Certified safety glass**⁵.
5. **Zoom module** with 5x optical zoom, laser and LED.

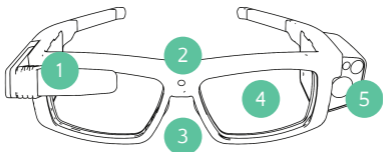

6. **Quad microphones array** for video calls and voice commands⁶.
7. **Cold-bendable temple tips** for user comfort.
8. **2.5mm audio jack** for mono audio with microphone.
9. **Coaxial connection** between headset and pocket unit.

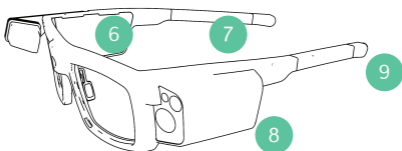

10. **Speaker** which is aimed towards the ear.
11. **Capacitive touch pad** which supports the gestures swipe forward, backward and down and single tap, double tap and long tap.
12. **9-axis sensor**: accelerometer, gyroscope, head motion detector, magnetic field detector and measurement of the absolute rotation of the headset.

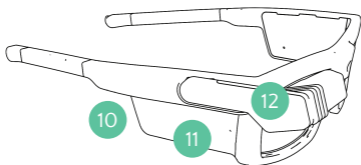

⁵ EN 166 S and ANSI Z.87 - see [Certifications](#) (p. 34) for more information.

⁶ Voice commands are only available on the Iristick. Z1 Premium.

Pocket unit

The pocket unit provides the headset with power and allows communication between the headset and the phone through the coaxial cable.

It has the following features:

1. **Magnetic bed** for mobile phone.
2. **USB Type-C connection** for mobile phone.
3. **Detachable USB cable** to charge the pocket unit by USB-C⁷ in case the barrel jack charging adapter is not available.
4. **Coaxial connection** to connect the headset.
5. **LED indicator** for battery status.
6. **Charging port** to charge the pocket unit with the 15V barrel jack charging adapter⁸.

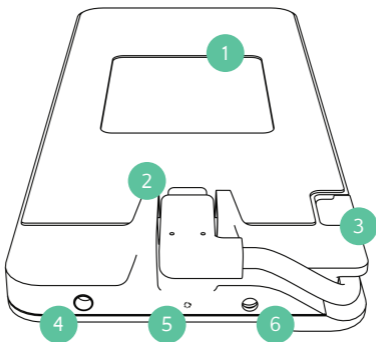

⁷ Please refer to [Charging & status > Charging by USB](#) (p. 22) for more information on how to charge via USB-C.

⁸ Please refer to [Charging & status > Connecting the charger](#) (p. 20) for more information about the barrel jack charging adapter.

Serial & model number

The serial number shown on the outside of both the headset and pocket unit, is the serial number of the casing and looks like A00000 (pocket unit – in the middle of the top surface) and B00000 (headset – on the left inner panel).

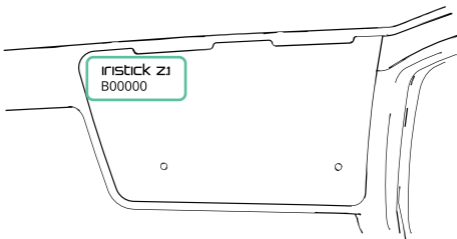

The internal serial number of the headset and pocket unit can be read-out by connecting the Iristick.Z1 to a mobile phone and launching the **Iristick Services** application. This is the serial number of the internal hardware and looks like 123456789A12x⁹ (pocket unit) or 123456789B12x⁹ (headset). The last part of the internal serial number shows the model number. A pocket unit has A12x as its model number and a headset has B12x.

 - It is advised to take note of the serial numbers of both the headset and pocket unit.

⁹ The serial number may contain a trailing letter ('x') to indicate a hardware revision.

Phone

Phone compatibility

In default mode, the Iristick.Z1 clones everything visible on the screen of your connected phone onto its heads-up display. This allows you to run almost any¹⁰ app installed on your phone on the heads-up display on the headset.

The Iristick.Z1 product line is compatible with most Android mobile phones¹¹ with at least Android 7 and a USB-C connector with host mode enabled.

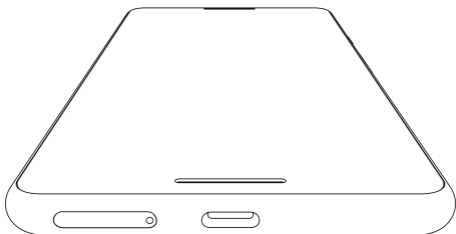

¹⁰ Not all applications are optimized to work with either voice commands or the accessibility layer that the Iristick's touchpad relies on to detect, highlight and click on-screen buttons.

¹¹ Please refer to the list of supported (and unsupported) phones at our support page at <https://supportiristick.com/> or send us an email at support@iristick.com.

Metal plate

The phone will stick magnetically to the top surface of the pocket unit when the metal plate is adhered to the back of the phone.

The easiest way to do this, is as follows:

1. Remove the paper from the back of the metal plate to expose the adhesive.
2. Place the metal plate onto the middle of the pocket unit surface with the bottom aligned and the adhesive side at the top. You will notice that the plate is a bit larger than the cutout. This is to avoid scratches and allows the phone to slide more smoothly across the surface, down to the USB Type-C connector.

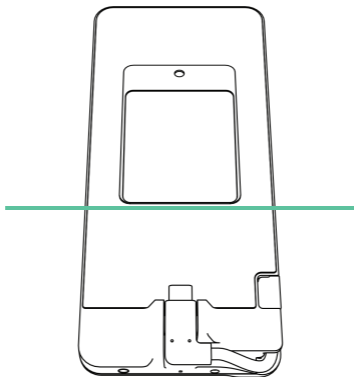

3. Carefully connect the phone to the pocket unit by USB while having the phone lifted from the surface and the metal plate.

 - Push down on the outside of the USB connector to lift up the USB-C connector on the inside.

4. Align both the left and right side of the phone with both sides of the pocket unit and gently push the phone down towards the surface of the pocket unit.

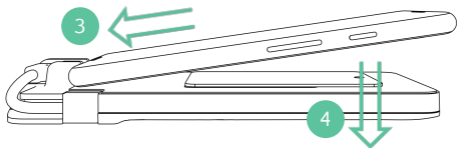

Software

Iristick Services

In order to use any of the applications installed on the phone with the Iristick.Z1, it is necessary to install one very important application. This application is called **Iristick Services** and is the bridge between the hardware of the glasses and the software on the phone.

It is designed to work out of the box as it scans the screen for clickable items and guides you with highlights while you are navigating with the touchpad. In addition, it clones the phone's screen onto the heads-up display, routes the audio and processes voice commands¹² offline.

In the settings section of this application you can change for example the touchpad sensitivity, the brightness of the heads-up display and enable a remote screen share function called **Web console**¹³ which is very useful for developers and demonstrating purposes.

Synchronizing

Upon connection with the Android device, the **Iristick Services** application checks for differences in the firmware version of the Iristick Services itself, headset and pocket unit. If necessary, the devices will be synchronized automatically within a minute.

Synchronizing can be recognized by the following icon in the notification bar:

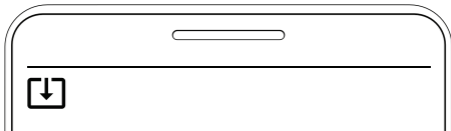

 - When the Iristick.Z1 gets disconnected while synchronizing, a fail-safe recovery mechanism will be triggered and the old firmware will be reloaded.

¹² Please note that voice commands are only available on the Iristick.Z1 Premium.

¹³ Please read more about **Web console** in the section [SDK & Development > Web console](#) (p. 32).

Setup

Please follow the steps below to set up the Iristick Services.

1. Download and install the **Iristick Services** application on the Android phone through Google Play, F-Droid (add the repository <https://apkiristick.com/release>) or via our developer webpage at <https://developeriristick.com/> > **Getting Started** > **Phone setup** > **Manually**.



¹⁴



2. Start **Iristick Services** and grant the permissions. You might need to open the notification drawer¹⁵ of the phone and tap the notification.

The '**Accessibility Service**' permission allows the usage of the touchpad to select items on the screen.

The '**Display over other apps**' permission allows us to highlight the selected buttons for easy navigation.



- *Some permissions might need to be allowed again after an update of the **Iristick Services**.*

3. Connect the phone to the pocket unit via USB-C by sliding it down on the soft surface. The phone will stick magnetically to the surface of the pocket unit, thanks to the metal plate¹⁶.

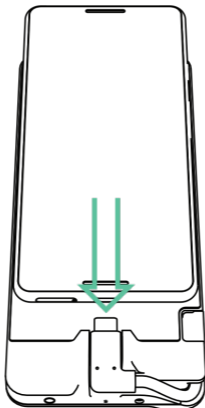

¹⁴ The Google Play logo is a trademark of Google LLC.

¹⁵ See our FAQ at <https://supportiristick.com/> on how to open the notification drawer to see the notifications.

¹⁶ See **Phone** > **Metal plate** (p. 12) for more information on how to attach the metal plate to the phone.

4. Tap 'OK' in the **Iristick Services** dialog box on the phone which is asking to 'Open Iristick Services to handle Smartglass?'.

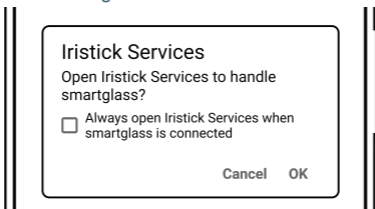

- You might find it useful to check the checkbox 'Always open Iristick Services when Smartglass is connected' to have the **Iristick Services** to start automatically upon connection.*

- The pocket unit's firmware might be synchronized. This will be shown in the notification bar.

5. Connect the headset to the pocket unit with the coaxial cable.

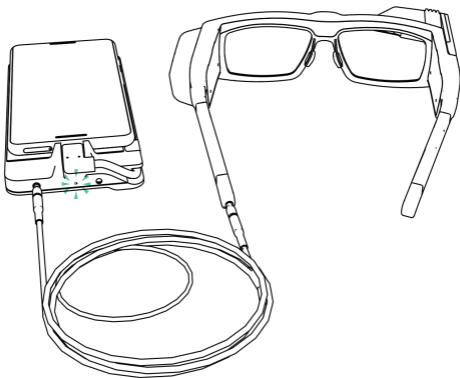

- The headset's firmware might also be synchronized. This will be shown in the notification bar.*

6. Tap '**START NOW**' in the **Iristick Services** dialog box on the phone to allow '**Iristick Services will start capturing everything that's displayed on your screen.**' to activate the heads-up display. This mirrors the phone's screen onto the heads-up display.

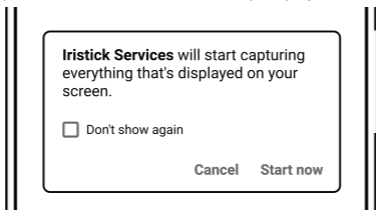

-  - You might find it useful to check the checkbox '**Don't show again**' to automatically mirror the screen upon connection.
- This notification looks different on Android 10. Also, the checkbox '**Don't show again**' has been removed.

Status

The status of the Iristick Services is shown in two ways:

1. By the LED on the pocket unit:
 - The LED on the pocket unit is dark blue if only the pocket unit is connected to the phone and initialized properly by the **Iristick Services**.
 - It will turn bright blue when the headset is also connected.
2. By the Iristick logo in the notification bar:

Only the outer ring of the Iristick logo is shown when only the pocket unit is connected to the phone and initialized properly by the **Iristick Services**.

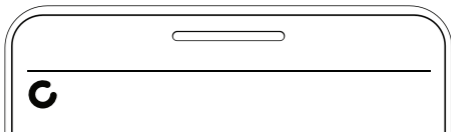

The full logo is shown when the headset is also connected.

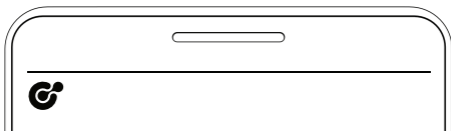

Wizzeye

Wizzeye is our free and open-source remote assistance demo application, created for our customers to quick start with the Iristick.Z1 and for demo purposes.

-  - Please note that we do not give any kind of support on **Wizzeye**. A full-fledged remote assistance application by one of our partners is strongly recommended. Refer to our webpage <https://iristick.com/partners/> to get to know our partners.

In order to start with **Wizzeye**, please follow the steps below:

- Install the latest version of **Wizzeye** through Google Play or via <https://wizzeyeapp/>.
 - Launch **Wizzeye**.
 - Grant the permissions.
 - Enter or generate a (new) room name.
 - Tap 'JOIN' to join this room on the **Wizzeye** server. Share this room within **Wizzeye** via the share button or have the remote observer (who is viewing the stream through a browser¹⁷) visit <https://wizzeyeapp/> and enter the same room name over there.
-  - Due to firewall restrictions, both devices need to be connected to the same network. Contact us to get your temporarily credentials to pass through firewalls¹⁸ by using a TURN server.
- Please note that only one glasses wearer (with the Iristick.Z1 and **Wizzeye** application) and one remote observer (via a browser) can be connected together at once.
 - Voice commands are disabled in **Wizzeye** when in a call to avoid interference while talking.

Iristick Examples

Install the **Iristick Examples** to get to know the Iristick.Z1 and try out all the functions the Iristick.Z1 offers in a simple and demonstrable way. You can, for example, see a viewfinder with both cameras¹⁹, test out the touchpad, scan barcodes and read out the sensors.

¹⁷ Please use a Chromium-based browser for the best performance.

¹⁸ Please make sure to open TCP port 433 for **Wizzeye**.

¹⁹ Please use the **Iristick Camera** application to actually shoot pictures and record videos.

Iristick Camera

When the **Iristick Services** have been installed, the **Iristick Camera** will be installed too as it is bundled with the **Iristick Services**.

This application allows you to take pictures or record video with either camera on the headset. It supports voice commands²⁰ on Iristick.Z1 Premium devices. The recordings will be saved on the internal storage of the mobile phone.

Iristick Image Viewer

When opening a picture from a file manager or gallery application while the Iristick.Z1 is connected, the image may be opened²¹ with the **Iristick Image Viewer**.

This viewer makes it possible to zoom and scroll over an image with the use of the touchpad, voice commands and even head rotation.

Partners

Refer to our webpage <https://iristick.com/partners/> to get to know our partners and the software solutions they have built for Iristick. You can contact them directly or send us an email at either info@iristick.com or support@iristick.com if you would like us to bring you into contact with the right software partner for the best-fitting solution.

If you happen to be a developer and you would like to join our partner program to get your software running on Iristick, please visit <https://iristick.com/developers/> or send us an email at info@iristick.com in order to get in touch with us. Our sales team is happy to help.

²⁰ Please refer to [Navigating > Voice commands](#) (p. 28) or <https://supportiristick.com/> for a list of these and all other available voice commands.

²¹ Depending on the default settings on which app Android should open to show images.

Charging & status

Pocket unit status

Check the battery status of your Iristick.Z1 before use by shaking the pocket unit gently back and forth. The LED indicator at the front of the pocket unit will indicate the level of charge and the connection status:

- Green = charged.
- Yellow = battery is running low.
- Red = depleted. Please charge the pocket unit.
- Dark blue = connected to a mobile phone.
- Bright blue = connected to both headset and mobile phone.
- ★ Blinking (any color above) = charging (with color status).

Swappable plugs

The AC/DC adapter comes with 4 interchangeable plugs for the following regions:

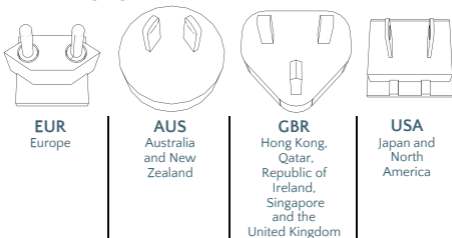

To apply one of the plugs, slide the plug down from the top onto the adapter until you hear a “click” sound.

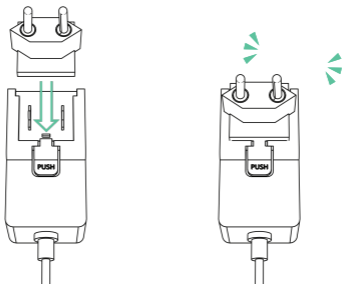

To change the plug, pull the plug towards the top while pushing the “push” button.

Connecting the charger

Simply connect the AC/DC adapter as shown below, to charge the pocket unit.

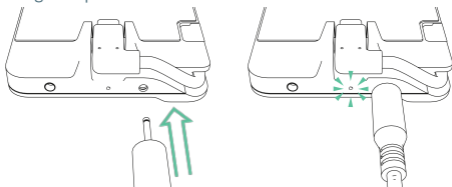

During charging, the LED will blink according to its status.

When the pocket unit is completely charged, the LED will stay solid green. Charging a depleted pocket unit should take around 2 hours²² maximum.

²² Please refer to [Charging & status > Battery & charger](#) (p. 23).

Charging the phone & pocket unit together

Some, mostly newer Android phones²³ support being charged along with the pocket unit. These phones are either:

1. Devices that only allow either data or power transfer cannot be used while charging. The USB port of the Android device only accepts one of the two options. If you connect the phone to the pocket unit before you connect the charger, the phone has already initiated the pocket unit for data transfer and the charger will not charge the phone. If you connect the charger first, the phone will detect the pocket unit as a charging device and gets charged by the pocket unit. The pocket unit will be charged by the charger.

 - Please keep in mind that in this case the phone will keep on charging on the pocket unit, even when the charger is disconnected from the pocket unit.

2. Devices that allow both data and power transfer can be used while charging. Here, it does not matter if you first connect the phone or the charger. We advise the usage of this type of phones²³.

You can always check the LED of the pocket unit or the **Iristick Services** application or its notification on the phone to see in which mode your device is in.

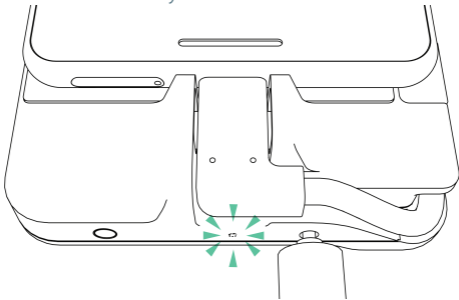

It will take more than 2 hours to completely charge both the pocket unit and an Android phone with a compatible 15V charger²⁴.

²³ See <https://supportiristick.com/> for a continuously updated list of supported (and unsupported) phones.

²⁴ Please refer to [Charging & status > Battery & charger \(p. 23\)](#).

Charging by USB

Alternatively, the pocket unit also allows charging by USB which could be useful in some cases. To charge by USB, please follow the steps below:

1. Pull the USB cable out of the pocket unit by pulling towards the side.

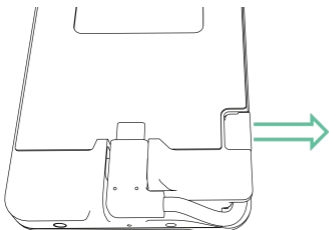

2. Push the USB charging cable into the pocket unit.

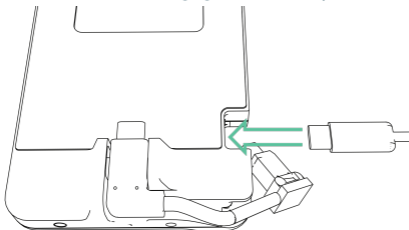

3. The LED will blink according to its battery status.

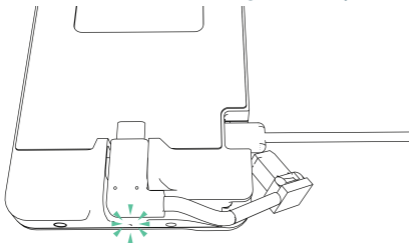

i - Please note that in this case the Iristick.Z1 cannot be used while charging, no matter which phone you are using. As the pocket unit is being charged by USB, the phone simply cannot connect to the pocket unit via the same USB port anymore.

Battery & charger

The battery type used in the Iristick's pocket unit²⁵ is a Lithium-Ion battery with a capacity of 1200mAh at 11.1V and is designed to be recharged. The Iristick.Z1 charges only with DC 5V (via USB) or 15V (both USB and barrel jack). Please only use chargers with the following specifications:

USB charger (via USB port only):

INPUT: 100-240V, 50/60Hz

OUTPUT: USB-C PD DC 5V/3A, 15V/1A

AC/DC adapter (via barrel jack only):

INPUT: 100-240V, 50/60Hz, 0.5A

OUTPUT: 15V = 1.0A

When charging the pocket unit with a USB 5V only output charger, the pocket unit might get hot and will charge slowly or not at all due to low current. A USB charger that supports PD (Power Delivery) and charges up to 15V is recommended.

When a compatible (USB or barrel jack) charger with 15V is connected, the LED will blink faster than when a 5V charger (USB) is connected. Please refer to the following patterns:

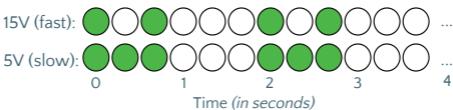

²⁵ Please refer to [Pocket unit \(p. 9\)](#) to get to know its features.

Adjustments

Temples

The temples can be adjusted to fit around the head or ears.

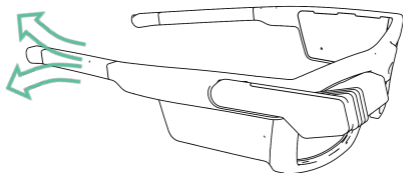

Heads-up display

The arm of the heads-up display can also be adjusted in four directions to the wearer's comfort. Line up the display right above the eye or completely out of sight for an unobstructed view.

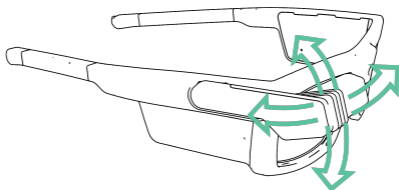

The heads-up display itself can also be rotated (or tilted) in two directions: to the front or to the back.

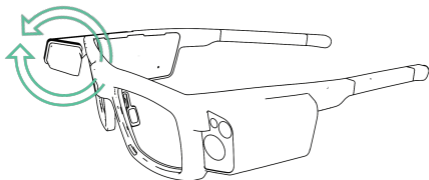

- i** - Best practice on how to position the heads-up display is to push the arm to the outside (right) and rotate the heads-up display itself downwards.
- The heads-up display can only rotate (or tilt) 30 to 40 degrees.

Nose pads

The nose pads can be adjusted for user comfort. Gently push and pull each pad to change its position.

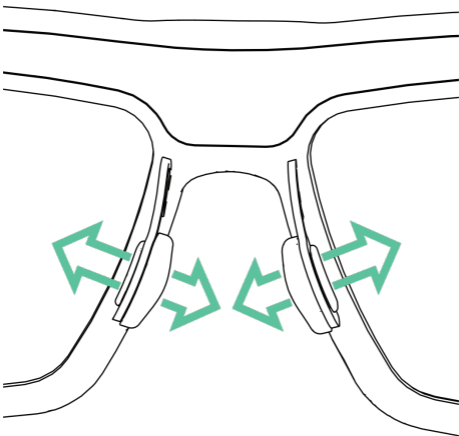

Insertable prescription glasses

The Iristick. Z1's headset is designed to fit prescription glasses to make the device usable for everyone. This, however, makes the Iristick.Z1 personal and can be costly. Therefore, we also offer the possibility to use insertable prescription glasses. In this way the Iristick.Z1 can be shared among multiple users.

You can buy the frame of insertable prescription glasses in our online store at <https://iristick.com/store/>. An optician can fit glasses into the frame according to a prescription.

To insert the inserts, please follow the steps below:

1. Place the insert sideways in the glasses.
2. Hook one side behind the nose pad by pushing down.

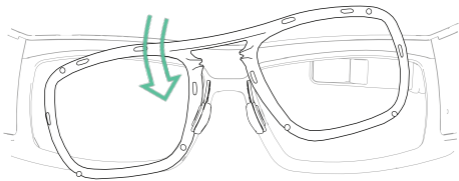

3. Hook the other side behind the other nose pad as well.

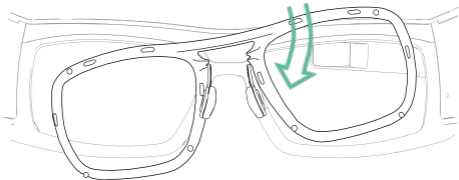

4. Adjust the nose pads as they might have been moved.

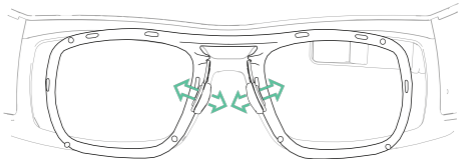

Navigation

Touchpad

In order to navigate through the items on the heads-up display, you can use the touchpad on the right side of the headset to select an item. The following gestures can be recognized:

- **Swipe forward:** swipe your finger over the touchpad from the back towards the front, away from the ear.

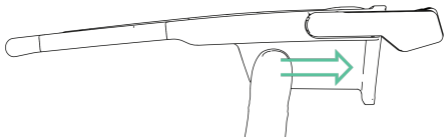

- **Swipe backward:** swipe your finger over the touchpad from the front towards the back, towards the ear.

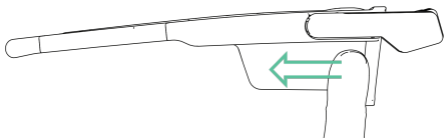

- **Swipe down:** swipe your finger over the touchpad in a downward motion.

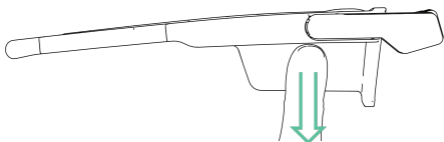

- **Single tap:** briefly touch ("tap") the touchpad.
- **Double tap:** tap twice in quick succession.
- **Long tap:** a single tap, but held for a longer time.



Voice commands

The Premium edition of the Iristick.Z1 can be controlled by voice commands. The labels of the buttons of the app are translated into voice commands.

 - Please note that only the Iristick.Z1 Premium can be controlled by voice commands.

Custom made applications or applications that are written for the Iristick.Z1 should be fully compatible with voice commands²⁶. Otherwise, you could always try to reach out to the developer or company behind the application you want to use.

The voice commands are available in multiple languages²⁷ and depend on the language of the phone. If the language of the phone is not available as voice command language, English will be used as default. The Iristick.Z1 can be used with the following English voice commands:

Global commands

Voice command	Action
Go backwards	Simulate back button
Scroll next page	Scroll down
Scroll previous page	Scroll up
Iristick suspend	Put phone to sleep
Iristick wake up	Wake up phone

Camera (picture)

Voice command	Action
Capture	Take picture
Switch camera	Toggle center/zoom camera
Record video	Switch to video recorder

Camera (video)

Voice command	Action
Start recording	Start recording video
Stop recording	Stop recording video
Pause recording	Temporarily pause recording
Resume recording	Resume paused recording
Switch camera	Toggle center/zoom camera
Take a picture	Switch to picture mode

²⁶ Some applications, like remote assistance solutions, may not have voice commands enabled to avoid interference while talking.

²⁷ Please refer to <https://supportiristick.com/> for the available languages and their associated voice commands.

Barcode scanner²⁸

Voice command	Action
Flashlight	Toggle flashlight

Iristick Image Viewer²⁹

Voice command	Action
Zoom in	Zoom in
Zoom out	Zoom out
Start moving	Unlock moving around
Stop moving	Lock moving around
Show overview	Go to overview
Show detail	Go back to (last) detail

Keyboard

Voice command	Action
Letter {A-Z}	Insert letter
Digit {0-9}	Insert digit
Symbol {?}	Insert symbol
Lowercase	Switch to lowercase
Uppercase	Switch to uppercase
All uppercase	Lock uppercase
Close keyboard	Close keyboard
Backspace character	Delete last character
Backspace word	Delete last word
Backspace line	Delete last line
Clear all	Delete everything

 - Multiple letters, digits or symbols may be spelled at once after saying the character category (e.g. saying 'Digit four two' will enter '42').

NATO phonetic alphabet

To increase precision, letters may be spelled using the NATO phonetic alphabet, which is as follows:

Character	Code word	Character	Code word
A	Alfa	N	November
B	Bravo	O	Oscar
C	Charlie	P	Papa
D	Delta	Q	Quebec
E	Echo	R	Romeo
F	Foxtrot	S	Sierra
G	Golf	T	Tango
H	Hotel	U	Uniform
I	India	V	Victor
J	Juliett	W	Whiskey
K	Kilo	X	Xray
L	Lima	Y	Yankee
M	Mike	Z	Zulu

²⁸ The **Iristick Examples** application contains a demo. Please refer to [Software > Iristick Examples](#) (p. 17) for more information.

²⁹ Please refer to [Software > Iristick Image Viewer](#) (p. 18) for more information about the **Iristick Image Viewer**.

Maintenance

Cleaning the glasses

The Iristick Z1 glasses can be cleaned with any regular screen cleaning spray that does not contain alcohol. Please make sure the cleaning spray states that it is **safe for all screen types**.

Spray the fluid directly on the glasses: one spray on each side on each glass, resulting in four sprays in total. Wipe the glasses with the cleaning cloth or use a microfiber-base cloth.

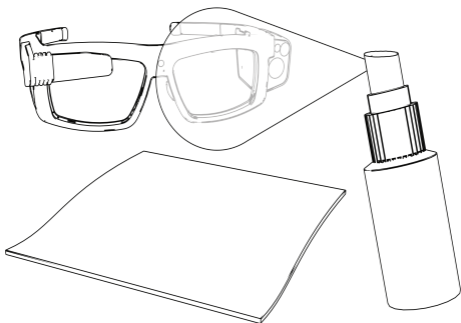

To avoid scratching or damaging the plastic surface of the safety glass, please:

- Make sure to blow off most dust and other particles before cleaning.
- Always use a clean (piece of) cloth.
- Never use paper or clothing as it may contain small but sharp particles.
- Always use a spray to clean the glasses.

Storing the glasses

The case has been designed to fit the complete Iristick.Z1 set, including the mobile phone and accessories. The set is best protected when using the following order of packaging:

1. Put the headset in place first.
2. The pocket unit goes in the middle.
3. The phone goes on top of the pocket unit and they stick together when the metal plate has been applied.
 - Please make sure to shut down the phone and disconnect the phone from the pocket unit to avoid potential overheating and battery draining.
4. Place the pouch upside down on top of the phone so it functions as a cushion.
5. The accessories go on the other side in the bag.

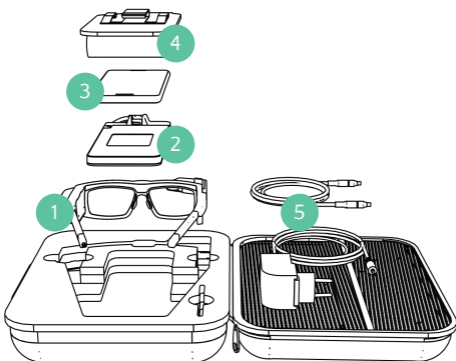

SDK & development

The Iristick SDK can be used for developing your own customized applications using the Iristick features. Software examples and documentation can be found at <https://developeriristick.com/>. For specific support on the SDK, please contact our support team at support@iristick.com.

Examples & source code

You can download the **Iristick Examples** application in order to have a brief overview of what the Iristick is capable of doing. The source code of this sample application can also be found on our developer page.

The source code of **Wizzeye** can be found on Github at <https://github.com/wizzeye/wizzeye/>. It contains both the code for the Android application and the server.

Web console

By enabling the **Web console** feature in the settings of the **Iristick Services**, you will be able to view the same information as shown on the heads-up display on the Iristick. Z1. Simply enter the complete web address (IP address and port number) that is shown underneath in a browser.

-  - The **Web console** only works when both the mobile device and the computer are connected to the same (Wi-Fi) network.
- It is advised to use Mozilla Firefox, as other browsers may lag one frame behind.

Partner program

If you are a developer or have developers in your company and you want your software running on the Iristick, please contact us to join our partner program. Take a look at <https://iristick.com/developers/> or send us an email at info@iristick.com in order to get in touch with us. Our sales team is happy to help.

Troubleshooting

We would be more than happy to help you out with any questions about or issues with your Iristick.Z1 device. Please visit <https://supportiristick.com/> and refer to the FAQ (Frequently Asked Questions) and the fault tree.

If you have a specific question or issue that is not listed in the FAQ or you need more help, simply send us an email at support@iristick.com and we will help you get an answer or solve the issue. Please provide us with the following information:

- The internal and/or external serial number³⁰ of both the headset and pocket unit.
- The brand and model number of the phone.
- The Android version³¹ running on the phone.
- A description of the problem.
- Symptoms you observe.
- Any additional information that can be of any use, like the internet connection used (2G, 3G, Wi-Fi 2.4GHz, 5GHz, ...), the location and/or apps that you have been trying to use.

When submitting an issue with the information above, we might ask you to provide us with your Iristick's debug log³² to give us more insight into what your Iristick.Z1 was doing and which application you tried to connect it to. To do so, please follow the steps below:

1. Open the **Iristick Services** application.
2. Tap '**Submit debug log**'.
3. Enter a brief explanation or refer to the above information you have provided earlier.

³⁰ The serial numbers can be found on the outside and in the **Iristick Services** application when the Iristick.Z1 is connected. Please refer to [Serial & model number \(p. 10\)](#) for more information.

³¹ The Android version can be found in your phone's [Settings > System > About phone](#).

³² Debug logs may contain personal data. Please refer to our Privacy Policy at <https://iristick.com/privacy-policy/>.

Certifications

CE

The Iristick.Z1 is fit for use in all European Union countries, Norway and Switzerland.



EN60950

Safety standard for audio, video or information communication technologies and the convergence of new technologies into state-of-the-art tech.

EN55032-CISPR32 Class B ITE (Information Technology Equipment)

This is a class B product. In a domestic environment this product may cause radio interference in which case the user may be required to take adequate measures.

IEC 60825-1:2014

IEC 60825-1:2014 class one is applicable to the safety of laser products emitting laser radiation in the wavelength range 180 nm to 1 mm.



This product complies with FDA performance standards for laser products except for conformance with IEC 60825-1 Ed. 3., as described in Laser Notice No. 56, dated May 8, 2019.

EN 166 S

Frame and lens must withstand the impact of a 22 mm steel ball weighing 43 grams dropped from 1.3 meters at a speed of 18 km/h. The lens must remain in the frame and may not shatter. The frame must remain intact as well.

FDA compliance

This product complies with FDA performance standards for laser products except for conformance with IEC 60825-1 Ed. 3., as described in Laser Notice No. 56, dated May 8, 2019.

Manufacturing information

Manufactured by Iristick NV, Lamorinièrestraat 123, 2018 Antwerp, BELGIUM.

Environmental information

Waste electrical & electronic equipment



This symbol on the product indicates that, under the European Directive 2012/19/EU governing waste from electrical and electronic equipment, this product must not be disposed of with other municipal waste. Please dispose of your waste equipment by handing it over to a designated collection point for the recycling of waste electrical and electronic equipment. To prevent possible harm to the environment or human health

from uncontrolled waste disposal, please separate these items from other types of waste and recycle them responsibly to promote the sustainable reuse of material resources. For more information about recycling of this product, please contact your local city office or your municipal waste disposal service.

Disposal of batteries in the product



This product contains batteries covered by the Directive 2006/66/EC which must be collected and disposed of separately from municipal waste. If the battery contains more than the specified values of lead (Pb), mercury (Hg) or cadmium (Cd), these chemical symbols will appear below the crossed-out wheeled bin symbol. By participating in separate collection of batteries, you will help to ensure

proper disposal and to prevent potential negative effects on the environment and human health.

RoHs compliance

Iristick, Z1 certifies that all materials used to make our products meet RoHs Compliance standards. Please contact us at either info@iristick.com or support@iristick.com for more details.

Barcode examples

UPC_A



UPC_E



QR Code



Iristick.Z1

Data Matrix



Iristick.Z1

Aztec



Iristick.Z1

PDF417



CODE_128



1234567890

CODE_39



IRI-1234

CODE 93



1 234567 890128

EAN_8



IRI-1234-/+

EAN_13



1234 5014



© 2020 Iristick NV

<https://iristick.com/>

Printed in The Netherlands
on 100% recycled paper

Please recycle if not used

